

Rotating Angle

Electric Diagram:
S.P.D.T

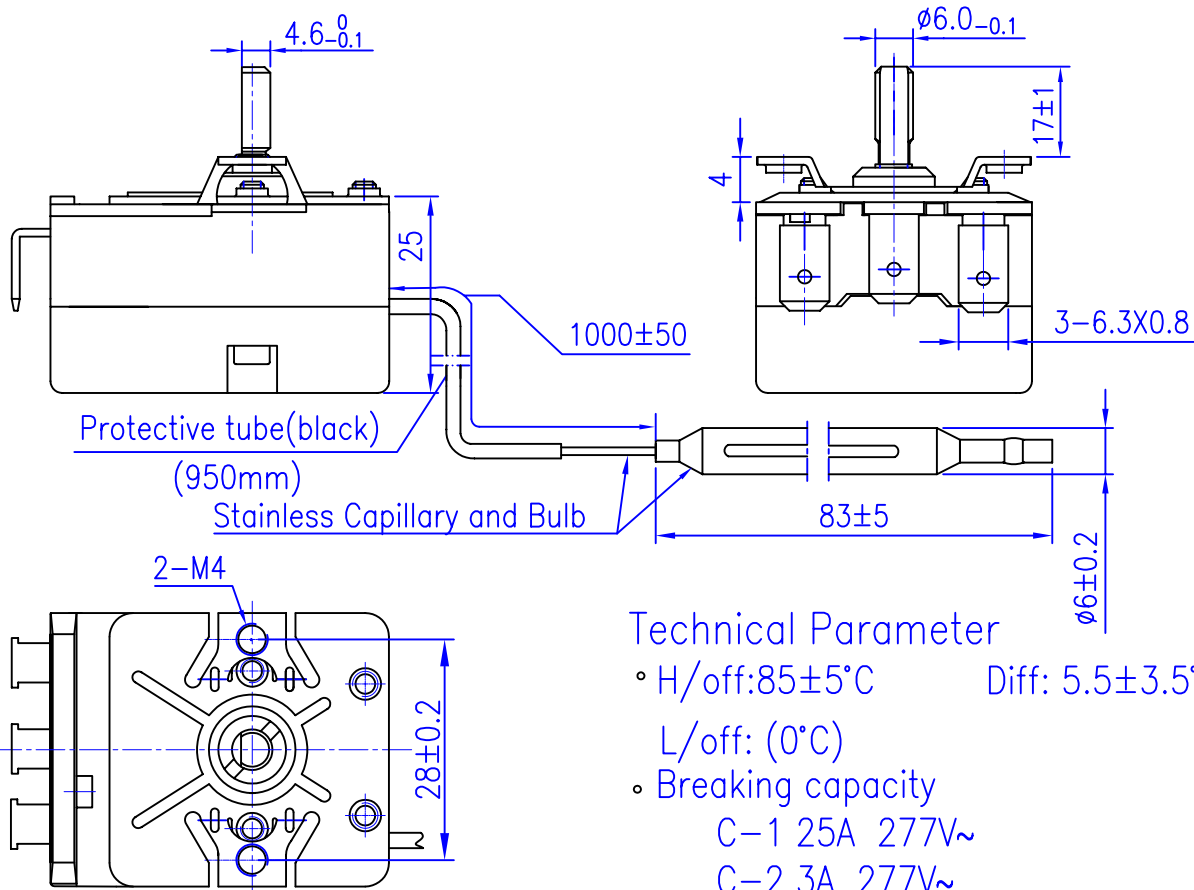
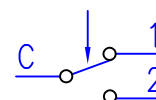
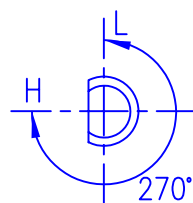

Technical Parameter

- H/off: $85 \pm 5^{\circ}\text{C}$ Diff: $5.5 \pm 3.5^{\circ}\text{C}$
- L/off: (0°C)
- Breaking capacity
C-1 25A 277V~
C-2 3A 277V~
- Insulation Resistance: $>100\text{M}\Omega$
- Dielectric Strength: AC 2000V 1min
- Temperature change speed: $<1.0^{\circ}\text{C}/\text{min}$
- Maximun temperature:
Around the Switch Body $T_{80^{\circ}}$
Around the Sensing Bulb 110°
- Rotating Torque of
Adjustment Shaft: $<0.4\text{Nm}$
- Life of Product: 30,000 Cycles

REMARK:

- 1.The operating temperature above is at 25°C ambient temperature (temperature around the switch body), if the ambient temperature changes, the operating temperature need to be modified.
Correction factor: $C = -0.22[\text{K}/\text{K}]$
2. The scheme shows the H position
- 3.Mounting screws must not touch thermostat body. Please use screws with proper length (5mm recommended).
4. Submerged capillary length: $50 \pm 30\text{mm}$.
- 5.The product has been given the following safty approval: CUL.

DRN		Liquid Expansion Type Thermostat	Customer: VETRA
CHD			Customer code:
ENG			Tongbao code: WYG85A-061-H
APPR		WIRING DIAGRAM	

SIGN	S
DATE	Mar.29.2012