

C (3:1)

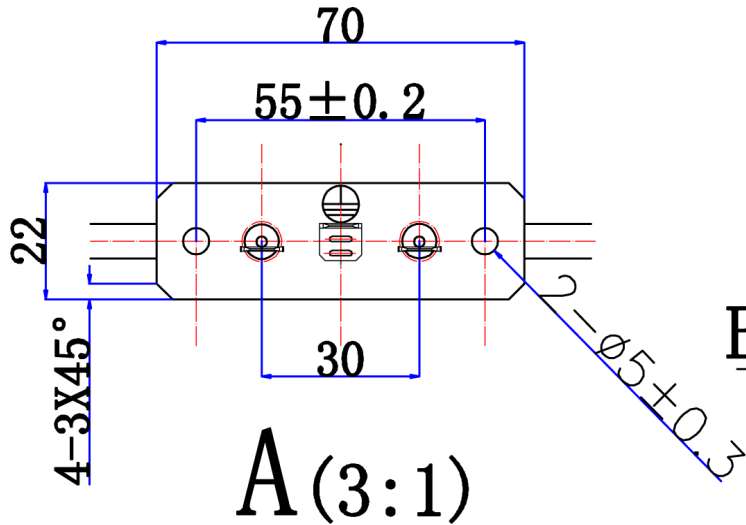

A (3:1)

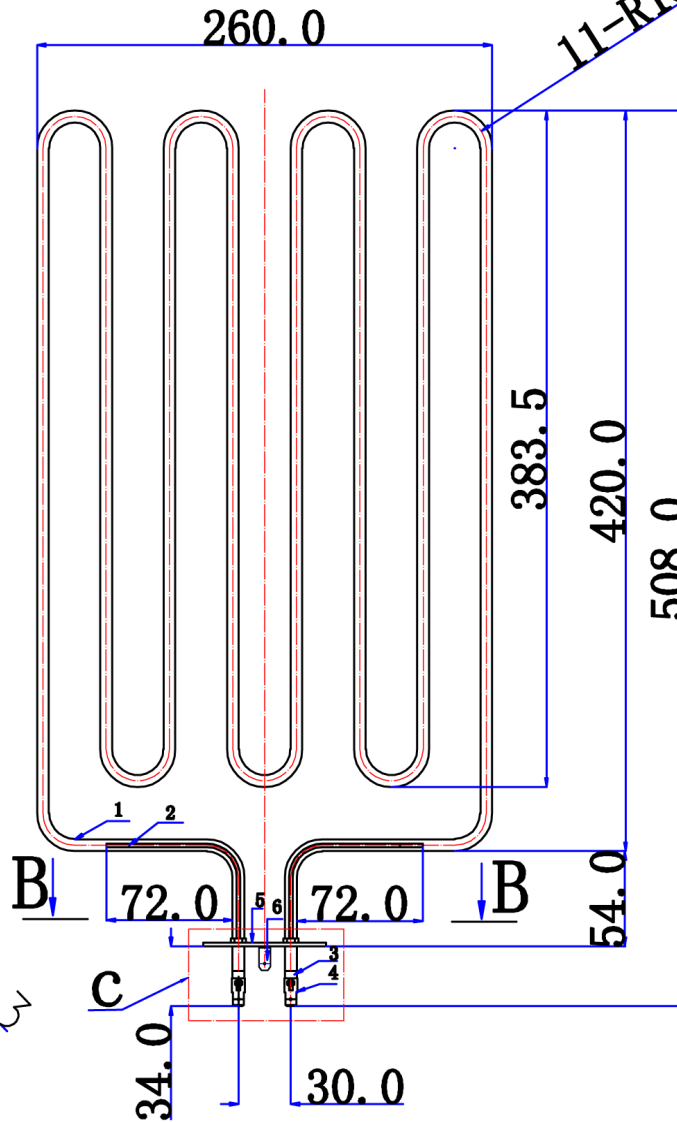

A

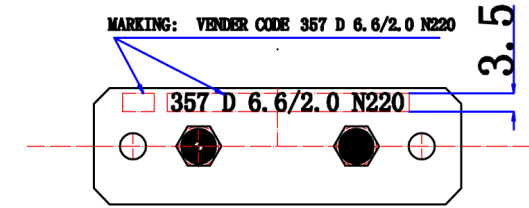

B-B (3:1)

NOTES:

1. POWER: 220V/2000W(+5%/-10%).
2. HI-POT ≥1500V/SEC, CUT OFF CURRENT:1mA.
3. INSULATION RESISTANCE: ≥100M Ω/DC500V, MIN
4. PROCESS:AL RADIATING.
5. LEAKAGE CURRENT TI BE 1.0mA MAX. WHILE ENERGIZED AT RATED VOLTAGE
6. TUBE:SUS304.
7. RESISTANCE WIRE MATERIAL:FE-CR WIRE.
8. INSULATED FILLER:MAGNESIUM OXIDE POWDER
9. LEAD-OUT ROD MATERIAL:#10 STEEL, PLATED.
10. SEALING MATERIAL:SILICON RUBBER.

ITEM	NAME	MATERIAL	RATING	QTY	CODE
6	GROUND TERMINAL	SUS430	250#-150°	1	
5	BRACKET	SUS430	70*22*2.0	1	
4	Connector	SUS430	250#-U -90°	4	
3	Connector	Ceramic	∅6.3X2.3X6	4	
2	COLD FIN	#10MILD STEEL	∅2.0±0.1	2	
1	SHEATH	SUS430	∅6.6±0.05	1	

MODEL: JL∅8.0G3084	DWG. NO: 20180413-1	SCALE: N.T.S	TITLE: HEATING TUBULAR ELEMENT	REV: A
-----------------------	------------------------	-----------------	-----------------------------------	-----------