

1. 12A (Res.) 250Vac T85 UL  
15A 250Vac T85/55 1E4 CQC  
16 (6) A 250Vac 125 TUV CE
2. 1750Vac 0.5mA 2S  
3750Vac 0.5mA 2S  
≥7MΩ 500Vdc ≤30mΩ

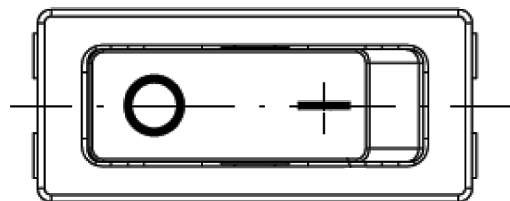

01	—	(INITIAL RELEASE)	CF	LSH	MAY. 04, 10
(REV.)	(REF.)	(DESCRIPTION)	(DRAW BY)	(APP. BY)	(DATE)
(NAME)	XCK-012-182	(NAME) /			
(MODEL NO.)	XCK-012-182	(DRAW BY)	CF	(APP. BY)	LSH
(PART NO.)	/	(SCALE)	NTS	(DATE)	MAY. 04, 2010
				(DATE)	

(Tolerance unless otherwise specified) X. = ± 0.2, .X = ± 0.15, .XX = ± 0.1, <= ± 1°, unit:mm

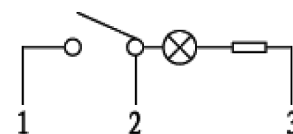
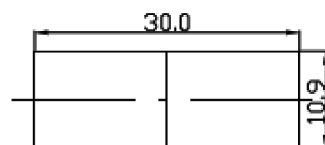