

Rotating Angle

Electric Diagram:

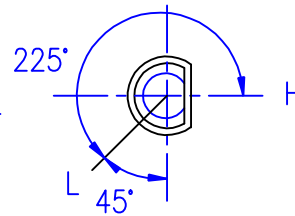

S.P.D.T

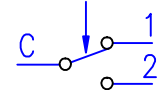

Technical Parameter

- H/off:  $80 \pm 5^{\circ}\text{C}$       Diff:  $5.5 \pm 3.5^{\circ}\text{C}$
- L/off:  $(30^{\circ}\text{C})$
- Breaking capacity
  - C-1 16(3)A 250V~
  - C-2 6(1)A 250V~
- Dielectric Strength: AC 2000V 1min
- Insulation Resistance:  $>100\text{M}\Omega$
- Temperature change speed:  $<1.0^{\circ}\text{C}/\text{min}$
- Maximum temperature:
  - Around the Switch Body  $T150^{\circ}\text{C}$
  - Around the Sensing Bulb  $120^{\circ}\text{C}$
- Rotating Torque of Adjustment Shaft:  $<0.4\text{Nm}$
- Life of Product:  $>40,000$  Cycles

REMARK:

1. The operating temperature above is at  $25^{\circ}\text{C}$  ambient temperature (temperature around the switch body), If the ambient temperature changes, the operating temperature needs modified.
2. The scheme shows the H (high) temperature position

DRN		Liquid Expansion Type Thermostat	Customer: VETRA
CHD			Customer code:
ENG			Tongbao code: WYF80L
DATE	Aug.24.2018	WIRING DIAGRAM	FOSHAN TONGBAO CO., LTD.

SIGN	S
DATE	Aug.24.2018