

EDG/EDS SERIES SLIDE TYPE

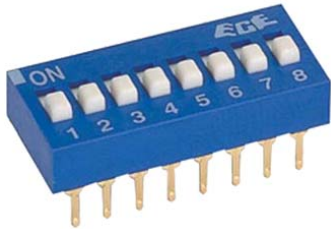

EDG/EDS SPST



EDG/EDS DPST

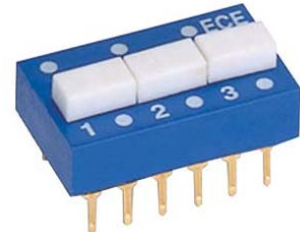

EDG/EDS SPDT

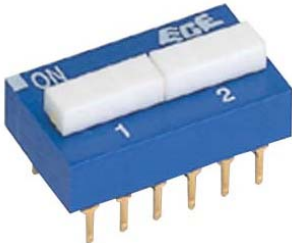

EDG/EDS 3PST

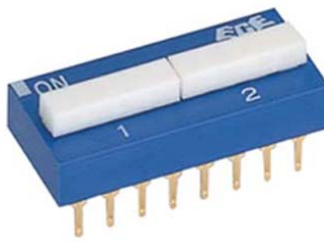

EDG/EDS 4PST

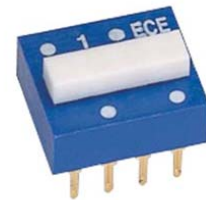

EDG/EDS DPDT

■ FEATURES

- Tactile response is performed directly by larger contact pressure to ensure very stable contact.
- All plastics are UL 94V-0 grade fire retardant.
- Bottom epoxy sealed standard to ensure free of flux immersion during wave soldering.
- Contact wiping on make and break.
- Gold, Silver, or Tin plated contacts to ensure low contact resistance and long mechanical life.
- Ideal for data processing, communications, remote controls and burglar alarm system use, where manual programming is required.
- RoHS Compliant

■ APPLICATIONS

- Numerical setting for computer terminal equipment
- Price setting for vending machines
- Programming for game machines
- Programming for industrial equipment and measuring instruments



■ SPECIFICATIONS

1.ELECTRICAL

| | |
|--|---|
| ● Contact rating | |
| switching | 25mA, 24VDC |
| non-switching | 100mA |
| ● Contact resistance | |
| initial | 50mΩ Max. |
| after life test | 100mΩ Max. (300mΩ Max. for Tin plated type) |
| ● Insulation resistance | 1000MΩ Min. at 100VDC |
| ● Dielectric strength | 500VDC Min. for 60 seconds |
| ● Capacitance between adjacent switches 5pF Max. | |

2.MECHANICAL AND ENVIRONMENTAL

| | |
|--------------------------------|--|
| ● Temperature rating | |
| operating | -25°C to + 70°C |
| Storage | -40°C to + 85°C |
| ● Operation force | 800g Max. (SPST only) |
| ● Mechanical life | 2000 operations |
| ● Humidity | 95% RH, 40°C for 96 Hrs. |
| ● Vibration | 10Hz-55Hz-10Hz for 6 Hrs. |
| ● Solderability | After flux 230±5°C for 5±0.5 seconds, 95% coverage |
| ● Resistance to soldering heat | 260±5°C for 5±1 seconds |

■ PART NUMBERING SYSTEM

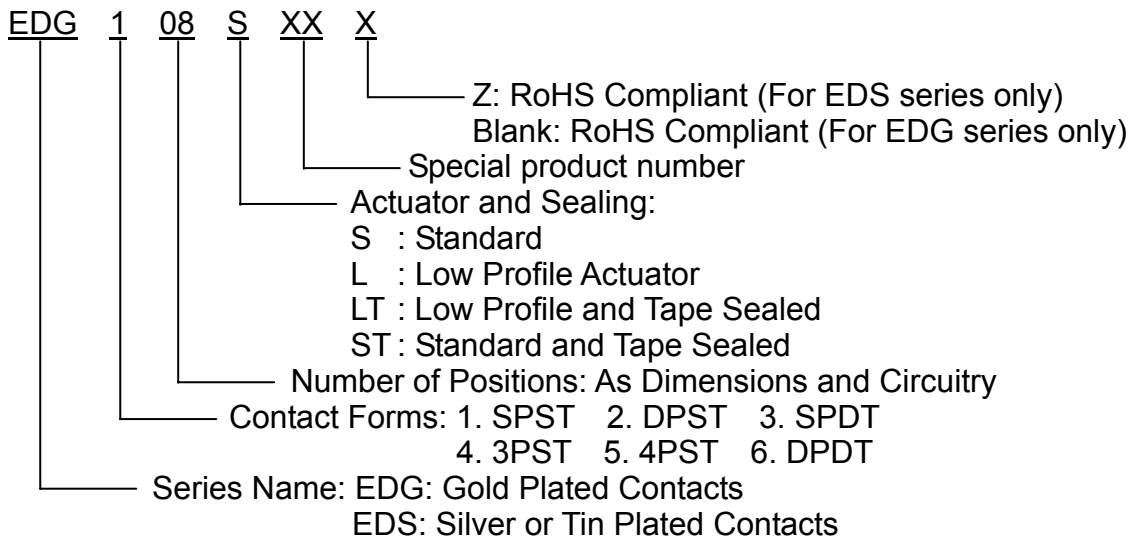

CONSTRUCTION

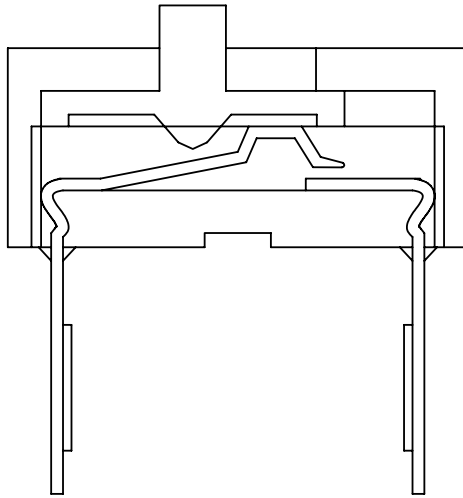

DIMENSIONS AND CIRCUITRY

EDG/EDS SPST SERIES

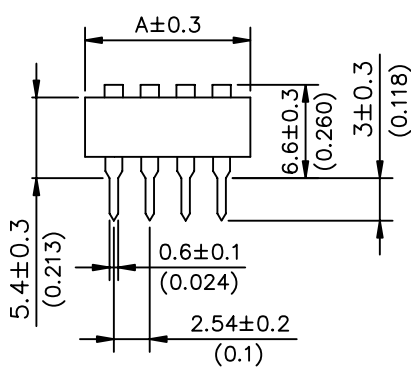
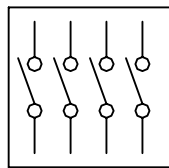
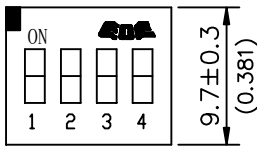

Extended type

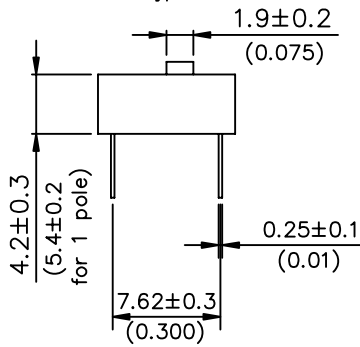

P.C.B. LAYOUT
(TOP VIEW)

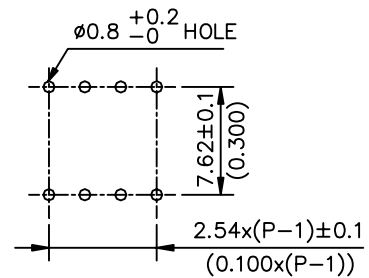

Dimension A

UNIT: mm(inch)

| Positions | 1 | 2 | 3 | 4 | 5 | 6 | 7 | 8 | 9 | 10 | 12 | 15 |
|-----------|-----------------|----------------|----------------|-----------------|-----------------|-----------------|-----------------|-----------------|-----------------|-----------------|-----------------|-----------------|
| A | 3.9* (0.154) | 6.7 (0.264) | 9.2 (0.362) | 11.7 (0.461) | 14.2 (0.559) | 16.7 (0.657) | 19.2 (0.756) | 21.7 (0.854) | 24.4 (0.953) | 26.7 (1.051) | 31.8 (1.252) | 39.5 (1.555) |

* The dimensions of the 1 pole switch may vary slightly.

EDG/EDS DPST SERIES

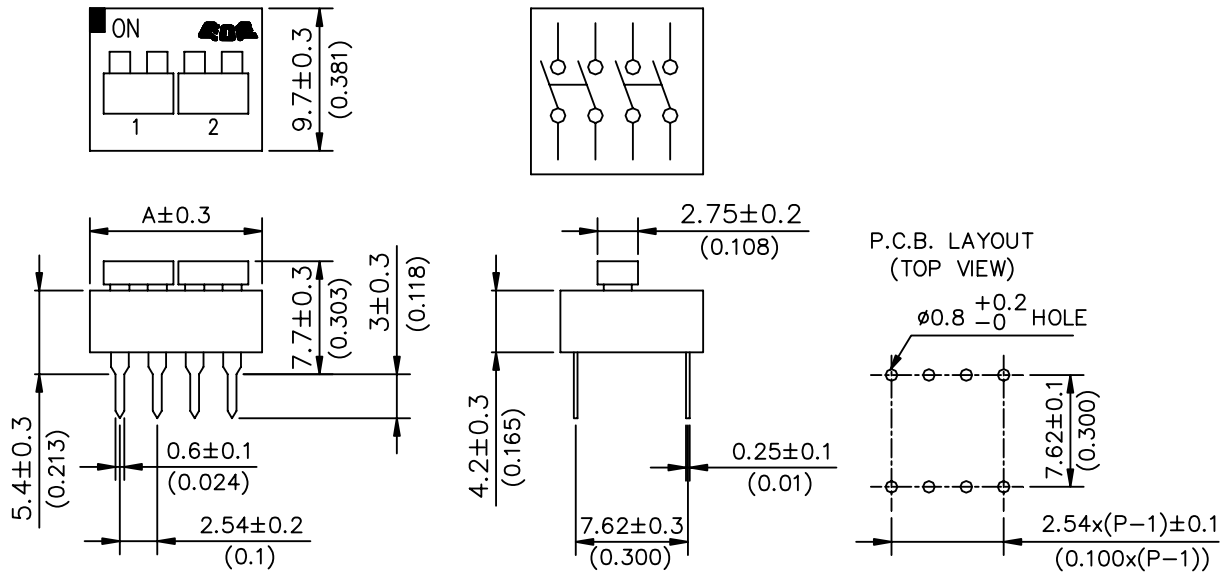

Dimension A UNIT: mm(inch)

| Positions | 1 | 2 | 3 | 4 | 5 | 6 |
|-----------|----------------|-----------------|-----------------|-----------------|-----------------|-----------------|
| A | 6.7 (0.264) | 11.7 (0.461) | 16.7 (0.657) | 21.7 (0.854) | 26.7 (1.051) | 31.8 (1.252) |

EDG/EDS SPDT SERIES

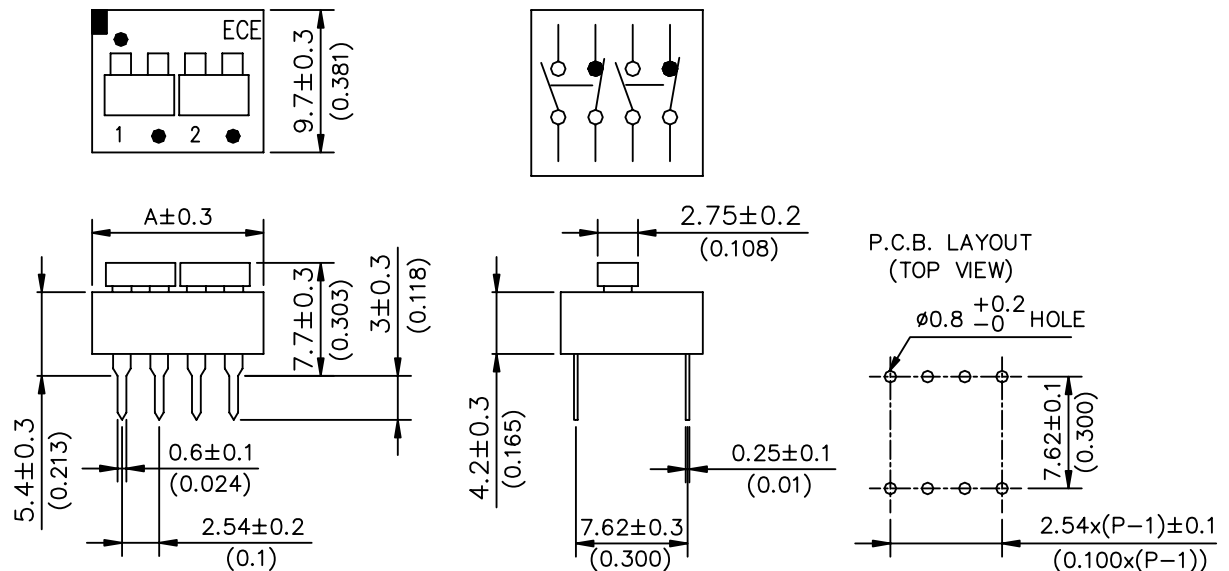

Dimension A UNIT: mm(inch)

| Positions | 1 | 2 | 3 | 4 | 5 | 6 |
|-----------|----------------|-----------------|-----------------|-----------------|-----------------|-----------------|
| A | 6.7 (0.264) | 11.7 (0.461) | 16.7 (0.657) | 21.7 (0.854) | 26.7 (1.051) | 31.8 (1.252) |

EDG/EDS 3PST SERIES

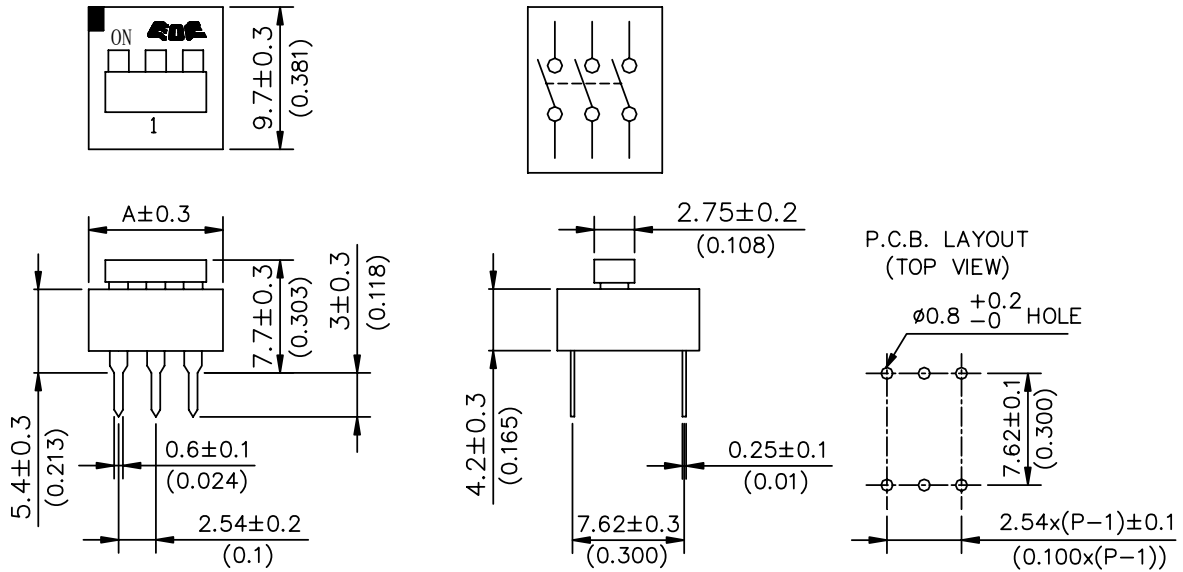

Dimension A UNIT: mm(inch)

| Positions | 1 | 2 | 3 | 4 | 5 |
|-----------|----------------|-----------------|-----------------|-----------------|-----------------|
| A | 9.2 (0.362) | 16.7 (0.657) | 24.2 (0.953) | 31.8 (1.252) | 39.5 (1.555) |

EDG/EDS 4PST SERIES

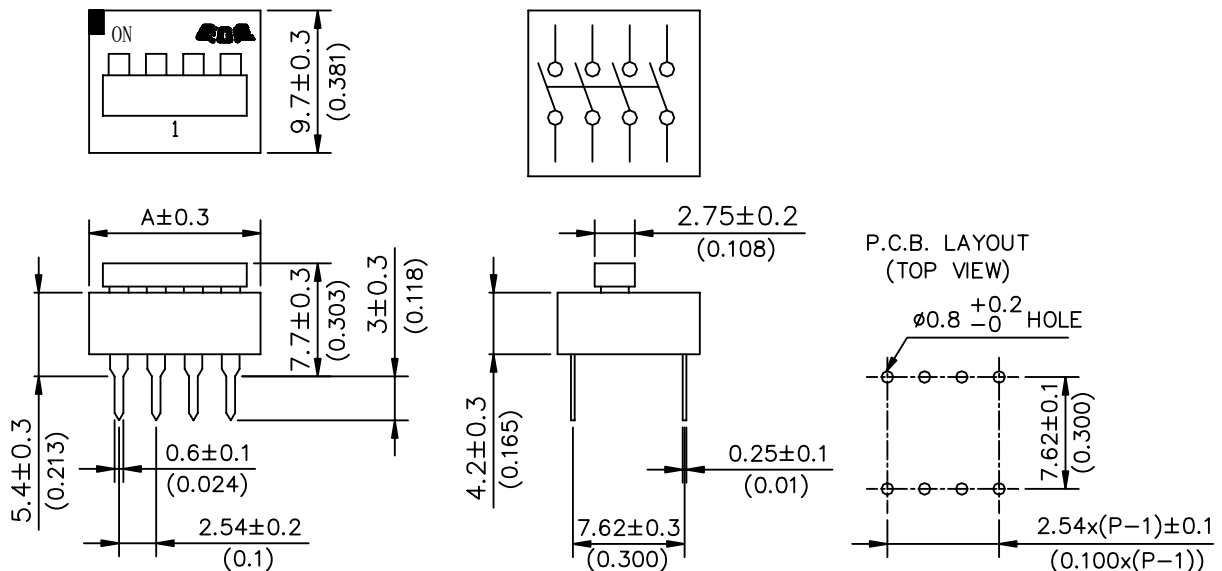

Dimension A UNIT: mm(inch)

| Positions | 1 | 2 | 3 |
|-----------|-----------------|-----------------|-----------------|
| A | 11.7 (0.461) | 21.7 (0.854) | 31.8 (1.252) |

EDG/EDS DPDT SERIES

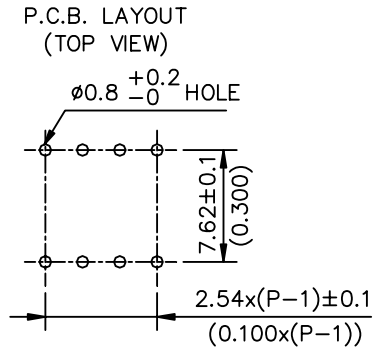
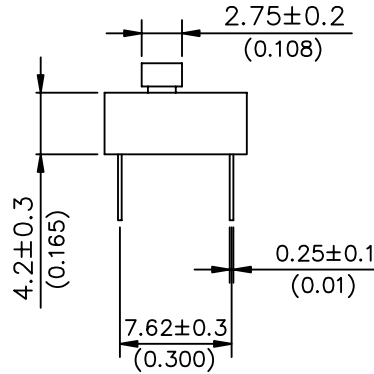
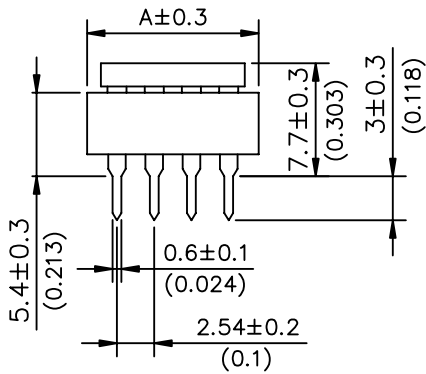
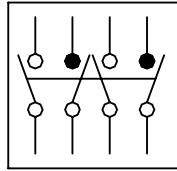
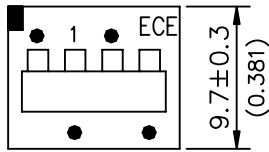

Dimension A UNIT: mm(inch)

| Positions | 1 | 2 | 3 |
|-----------|-----------------|-----------------|-----------------|
| A | 11.7 (0.461) | 21.7 (0.854) | 31.8 (1.252) |

■ **OPTIONS**

◆ **RIGHT ANGLE TYPE**

DIMENSIONS AND CIRCUITRY

DIMENSIONS A IS SAME AS PREVIOUS PAGE

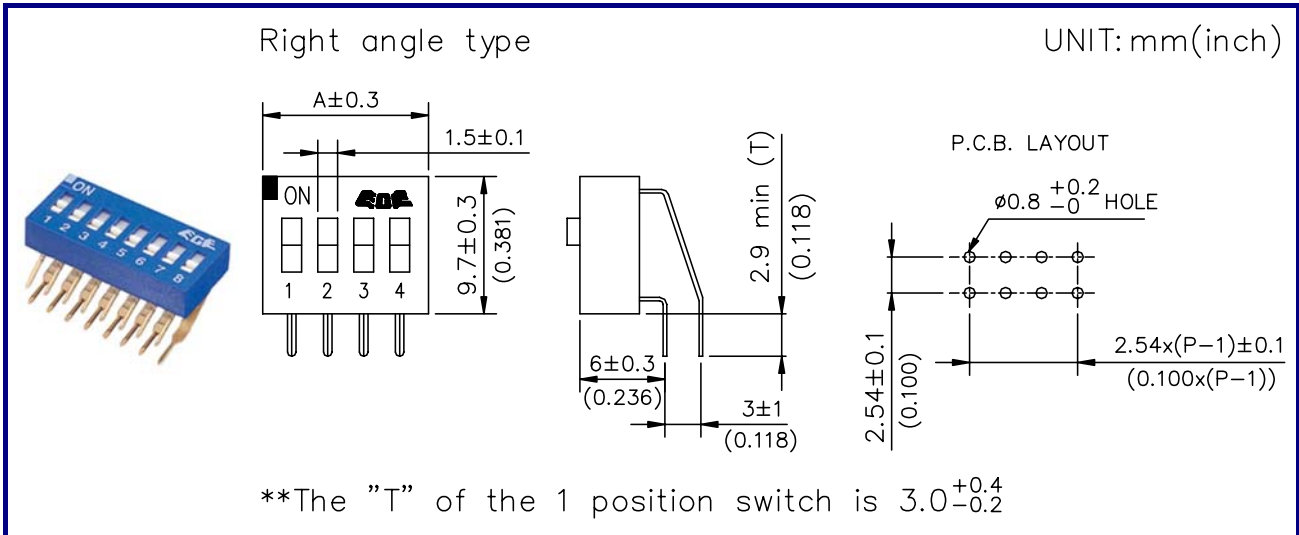

PART NUMBERING SYSTEM

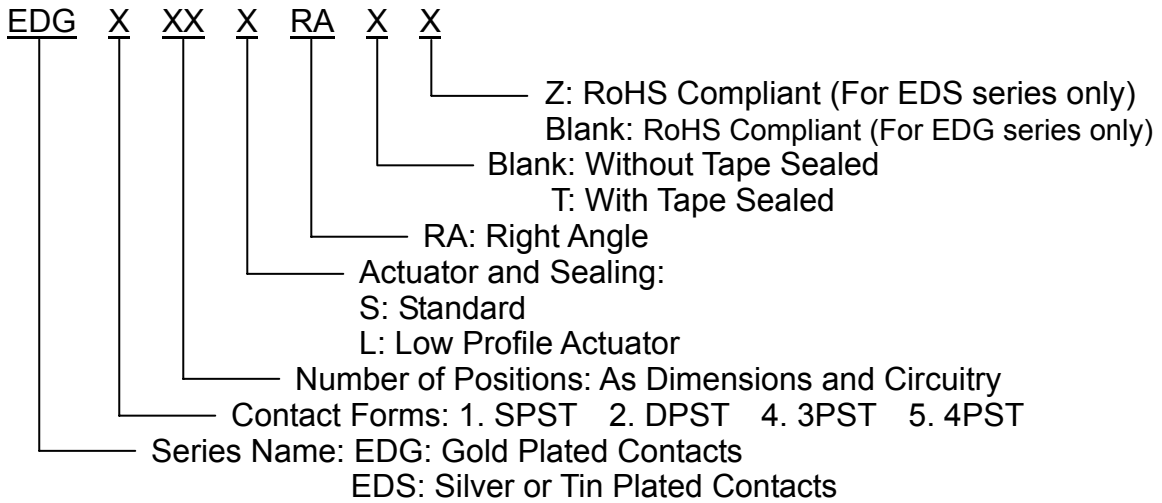

◆ **LOW PROFILE ACTUATORS**

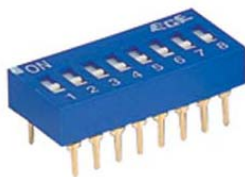

◆ **LOW PROFILE ACTUATORS AND TOP TAPE SEALED**

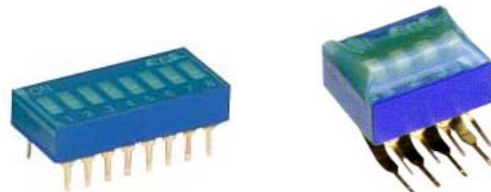

◆ **SPECIAL TOP OR SIDE MARKING AVAILABLE**